

Detectable Cable Tie Mounting Bases

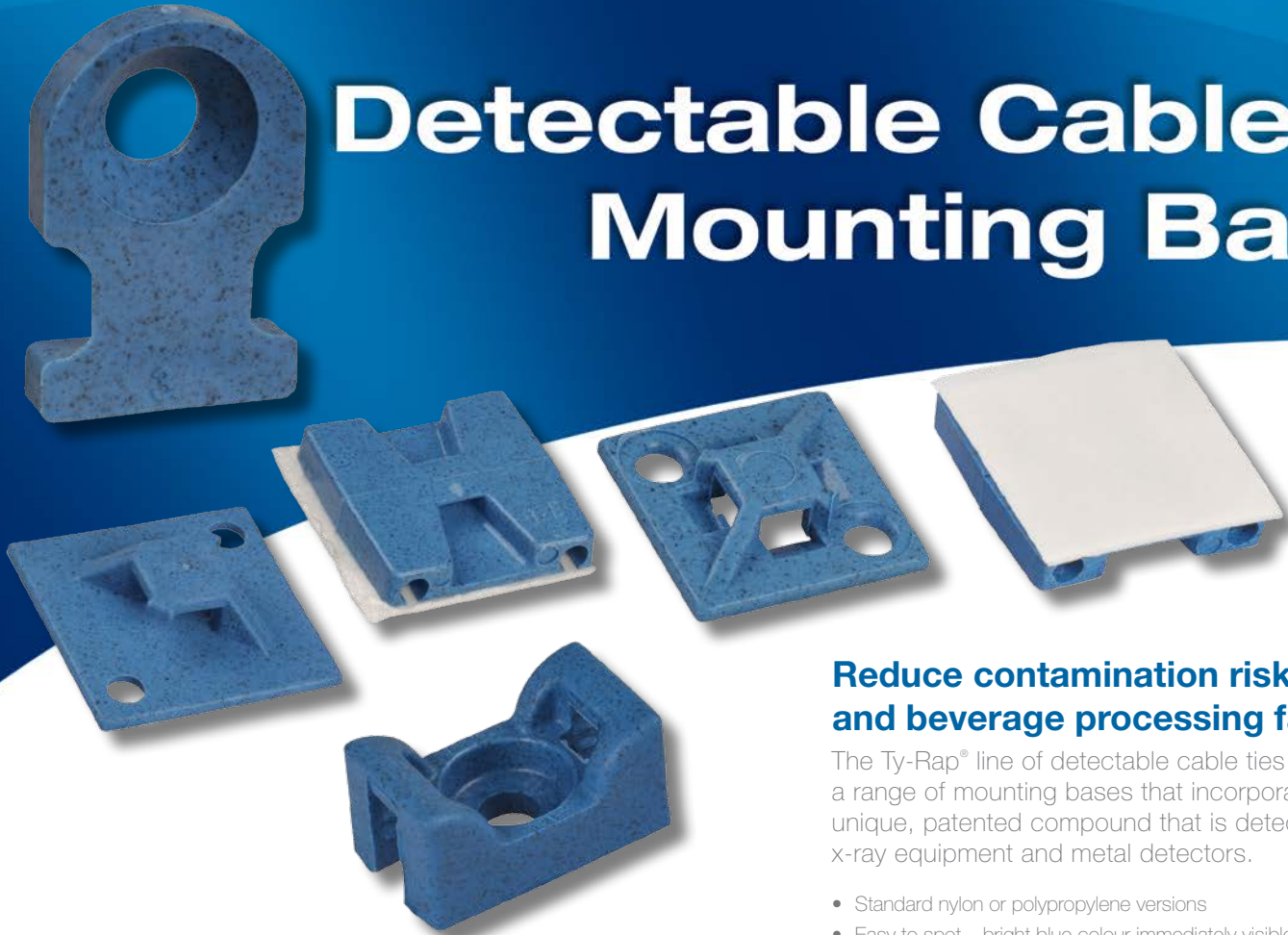

Reduce contamination risks in food and beverage processing facilities

The Ty-Rap® line of detectable cable ties now includes a range of mounting bases that incorporate the same unique, patented compound that is detectable by both x-ray equipment and metal detectors.

- Standard nylon or polypropylene versions
- Easy to spot – bright blue colour immediately visible
- Buoyant polypropylene version ideally suited for liquid processing environments
- One-piece molding eliminates risk of lost parts
- May aid companies to meet Canadian Food Inspection Agency (CFIA) regulations

Detectable by x-ray and metal detectors

Bright blue colour – easy to spot

One-piece molding – no lost parts



Thomas & Betts. Your best connection for innovative solutions.

Ty-Rap® detectable cable tie mounting base

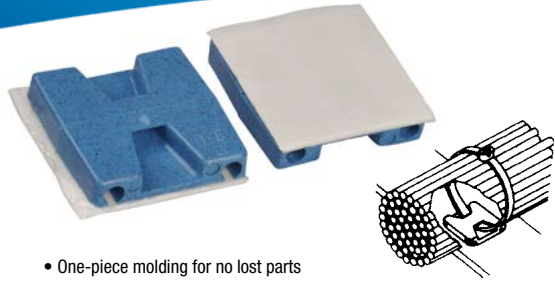

- One-piece molding for no lost parts
- An adhesive back with pressure-sensitive adhesive tape to quickly and securely mount the base

Mounting bases

Std. Pkg. Cat. No.	Bulk Pkg. Cat. No.	Mounting Method	Max. Tie Width Space (in.)	Length (in./mm)	Width (in./mm)	Std. Pkg. Qty.	Bulk Pkg. Qty.
Detectable Nylon 6/6							
TC5342A-NDT	TC342A-NDT	SRA* Adhesive	0.19	1.13/28.58	1.13/28.58	10	1,000
Detectable Polypropylene							
TC5342A-PDT	–	SRA* Adhesive	0.19	1.13/28.58	1.13/28.58	10	–

Four-way adhesive mounting bases

Std. Pkg. Cat. No.	Bulk Pkg. Cat. No.	Mounting Method	Max. Tie Width Space (in.)	Length (in./mm)	Width (in./mm)	Std. Pkg. Qty.	Bulk Pkg. Qty.
Detectable Nylon 6/6							
TC5344A-NDT	TC344A-NDT	SRA* Adhesive	0.14	0.75/19.05	0.75/19.05	100	1,000
TC5347A-NDT	TC347A-NDT	SRA* Adhesive	0.30	1.13/28.58	1.13/28.58	100	1,000
Detectable Polypropylene							
TC5344A-PDT	–	SRA* Adhesive	0.14	0.75/19.05	0.75/19.05	100	–
TC5347A-PDT	–	SRA* Adhesive	0.30	1.13/28.58	1.13/28.58	100	–

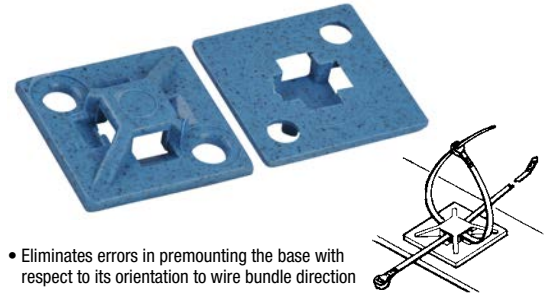

- Eliminates errors in premounting the base with respect to its orientation to wire bundle direction

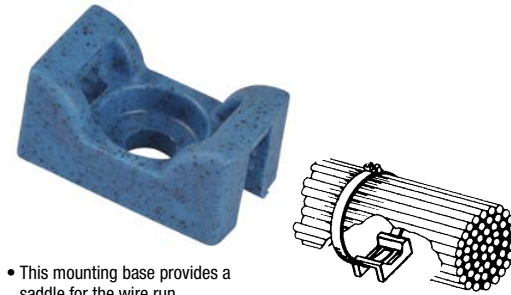

- This mounting base provides a saddle for the wire run
- Ty-Rap® detectable cable tie can be threaded under bundle and tied in the usual manner

Saddle support bases

Std. Pkg. Cat. No.	Bulk Pkg. Cat. No.	Mounting Method	Max. Tie Width Space (in.)	Length (in./mm)	Width (in./mm)	Std. Pkg. Qty.	Bulk Pkg. Qty.
Detectable Nylon 6/6							
TC5140-NDT	–	#4 pan head	0.091	0.344/8.84	0.563/14.30	100	–
TC5141-NDT	TC141-NDT	#6 pan head	0.190	0.439/11.15	0.672/17.07	100	500
TC5142-NDT	TC142-NDT	#10 pan head	0.301	0.563/14.30	0.922/23.42	100	500
Detectable Polypropylene							
TC5141-PDT	–	#6 pan head	0.190	0.439/11.15	0.672/17.07	100	500
TC5142-PDT	–	#10 pan head	0.301	0.563/14.30	0.922/23.42	100	500

Low-profile two-way miniature mounting bases

Std. Pkg. Cat. No.	Bulk Pkg. Cat. No.	Mounting Method	Max. Tie Width Space (in.)	Length (in./mm)	Width (in./mm)	Std. Pkg. Qty.	Bulk Pkg. Qty.
Detectable Nylon 6/6							
TC5102-NDT	TC102-NDT	#8 screw	0.19	0.50/12.70	0.75/19.05	100	1,000
Detectable Polypropylene							
–	TC102-PDT	#8 screw	0.19	0.50/12.70	0.75/19.05	–	1,000

* SRA = Synthetic Rubber Adhesive
 Storage/Surface Temp: 0°C to 48°C (32°F to 120°F)
 Application Temp: 18°C to 37°C (65°F to 100°F)

Surface preparation: Surface should be cleaned with alcohol-based cleaner before application.

Installation: Surface must be clean and dry prior to application of mount. Allow 15 minutes setting time for maximum adhesion performance of synthetic rubber adhesive.

Note: See product expiration date on package. Periodically check product for adhesion and replace as needed. Product is for wire management only and is not intended for use as a primary support of wire, cable, etc.



Atlantic Provinces

Thomas & Betts Limited
 Tel.: (902) 450-1307
 Toll Free: 1-877-862-4357
 Fax: (902) 450-1309

Quebec

Thomas & Betts Limited
 Tel.: (450) 466-1102
 Toll Free: 1-800-465-1399
 Fax: (450) 466-1163

Ontario

Thomas & Betts Limited
 Tel.: (905) 858-1010
 Toll Free: 1-877-291-7771
 Fax: (905) 858-1080

Manitoba / Saskatchewan

Thomas & Betts Limited
 Tel.: (604) 598-9811
 Toll Free: 1-866-540-8220
 Fax: (604) 598-9840

Alberta

Thomas & Betts Limited
 Tel.: (780) 424-7092
 Toll Free: 1-888-664-5666
 Fax: (780) 424-7093
 Toll Free: 1-866-424-4082

British Columbia

Thomas & Betts Limited
 Tel.: (604) 598-9811
 Toll Free: 1-866-540-8220
 Fax: (604) 598-9840