

Nonmetallic - Strut systems

Superstrut™ fittings and brackets

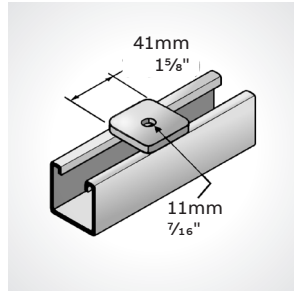

01

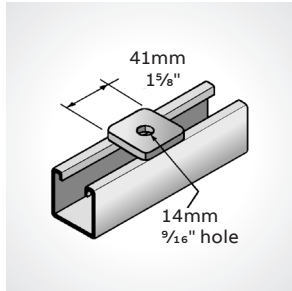

02

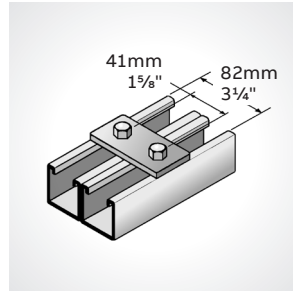

03

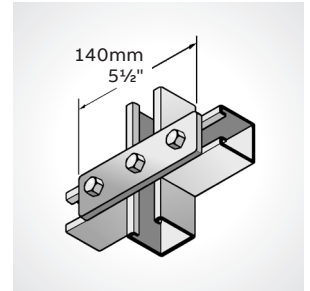

04

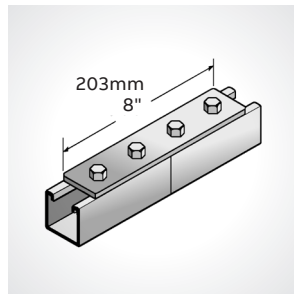

05

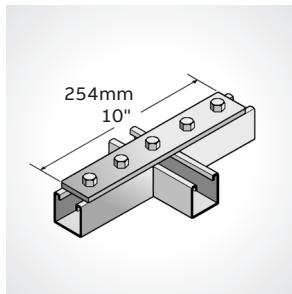

06

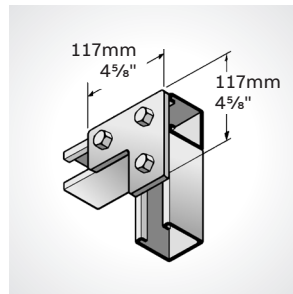

07

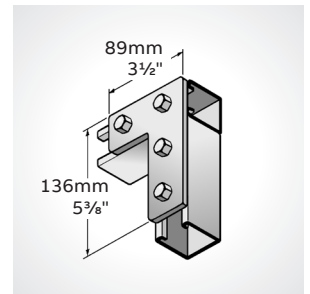

08

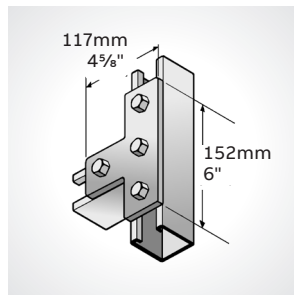

09

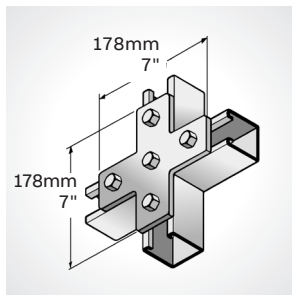

10

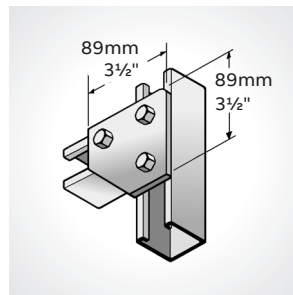

11

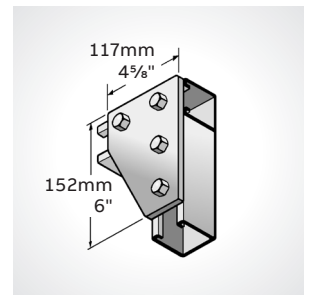

12

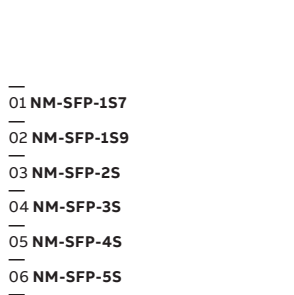

13

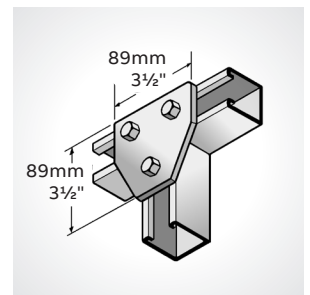

14

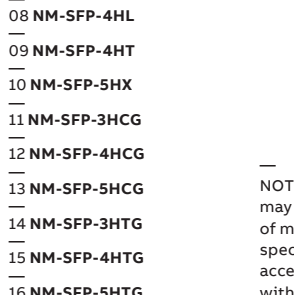

15

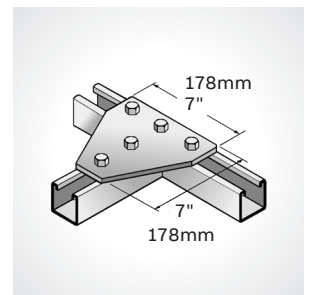

16

- 01 NM-SFP-1S7
- 02 NM-SFP-1S9
- 03 NM-SFP-2S
- 04 NM-SFP-3S
- 05 NM-SFP-4S
- 06 NM-SFP-5S
- 07 NM-SFP-3HL
- 08 NM-SFP-4HL
- 09 NM-SFP-4HT
- 10 NM-SFP-5HX
- 11 NM-SFP-3HCG
- 12 NM-SFP-4HCG
- 13 NM-SFP-5HCG
- 14 NM-SFP-3HTG
- 15 NM-SFP-4HTG
- 16 NM-SFP-5HTG

NOTE: Based on individual applications, changes may be required on dimension and thickness of material. All fittings are 3/4" (6mm) thick unless specified otherwise. All holes are drilled to accept 3/8" and 1/2" bolts with washers. Not supplied with hardware.

Nonmetallic - Strut systems

Superstrut™ fittings and brackets

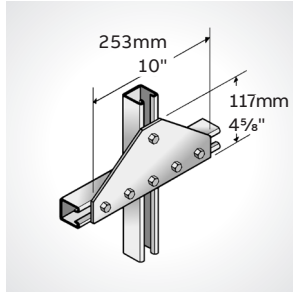

01*

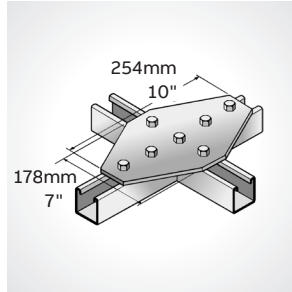

02*

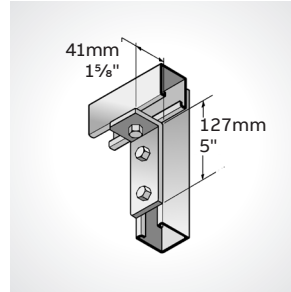

03*

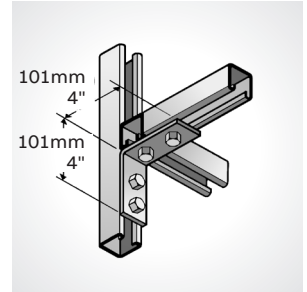

04*

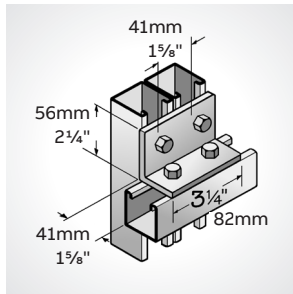

05*

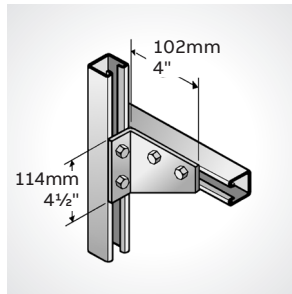

06*

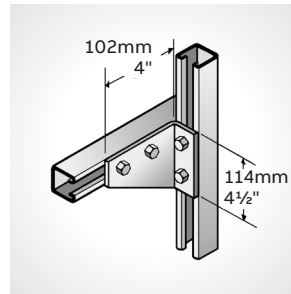

07*

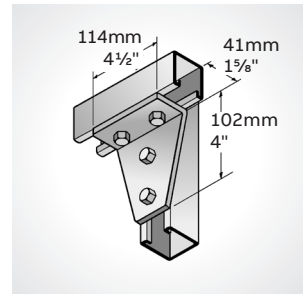

08*

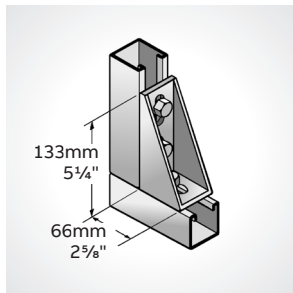

09

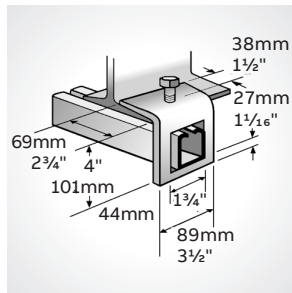

10

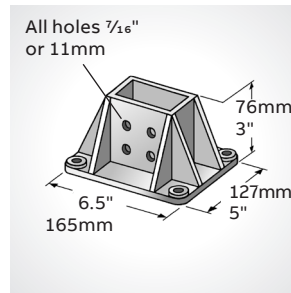

11



12

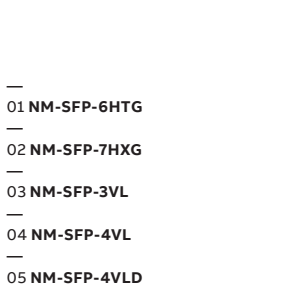

09

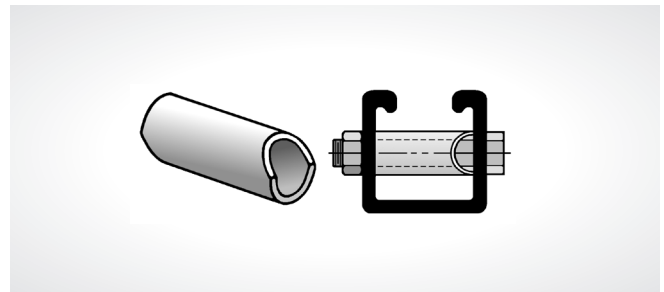

13

01 NM-SFP-6HTG

02 NM-SFP-7HXG

03 NM-SFP-3VL

04 NM-SFP-4VL

05 NM-SFP-4VLD

06 NM-SFP-4VGL

07 NM-SFP-4VGR

08 NM-SFP-4VTG

09 NM-SFP-3CB

10 NM-SWC-158

11 NM-SSV-DBASE

12 NM-SSV-SBASE

13 NM-SCSP-158

* Items 2 thru 8 (FRP angle components) will not support tensile loads or forces.

NOTE: Based on individual applications, changes may be required on dimension and thickness of material. All fittings are 1/4" (6mm) thick unless specified otherwise. All holes are drilled to accept 3/8" and 1/2" bolts with washers. Not supplied with hardware.