

Conduit bodies



Type LB

- Hubs are not threaded
- Textured lids
- Foam-in-place gasket

Cat. No.	Size (in.)	Std. ctn. qty.	Typical C	Max. L1 (in.)	Typical (in.)				Max. (in.)		Vol. (cu. in.)
					L2	L3	H	Q	W		
E986D	½	25	1 ¹ / ₁₆	4 ⁵ / ₁₆	3 ⁷ / ₃₂	3 ¹ / ₁₆	1 ⁵ / ₁₆	1 ¹¹ / ₃₂	1 ¹ / ₂	4.0	
E986E	¾	15	2 ⁹ / ₃₂	6 ⁹ / ₃₂	5 ⁹ / ₃₂	4 ²⁵ / ₃₂	1 ²⁵ / ₃₂	1 ³ / ₄	2 ¹ / ₃₂	12.0	
E986F	1	10	2 ⁹ / ₃₂	6 ⁹ / ₃₂	5 ⁹ / ₃₂	4 ²⁵ / ₃₂	1 ²⁵ / ₃₂	1 ³ / ₄	2 ¹ / ₃₂	12.0	
E986G	1¼	10	1 ³ / ₃₂	7 ³¹ / ₃₂	6 ¹³ / ₃₂	6	2 ⁵ / ₁₆	2 ¹ / ₂	2 ³ / ₄	32.0	
E986H	1½	10	1 ³ / ₃₂	7 ³¹ / ₃₂	6 ¹³ / ₃₂	6	2 ⁵ / ₁₆	2 ¹ / ₂	2 ³ / ₄	32.0	
E986J	2	10	1 ⁵ / ₃₂	9 ³¹ / ₃₂	8 ¹³ / ₃₂	7¼	2 ⁹ / ₁₆	3 ⁵ / ₃₂	3 ¹⁵ / ₃₂	63.0	
E986K	2½	4	1 ⁵ / ₈	14 ⁷ / ₈	13¼	11 ³¹ / ₃₂	3¾	4 ¹¹ / ₃₂	4 ⁵ / ₈	210.0	
E986L	3	4	1 ⁵ / ₈	14 ⁷ / ₈	13¼	11 ³¹ / ₃₂	3¾	4 ¹¹ / ₃₂	4 ⁵ / ₈	210.0	
E986M	3½	4	1 ²⁵ / ₃₂	17 ²³ / ₃₂	15 ⁷ / ₈	14 ¹⁷ / ₆₄	4 ⁷ / ₁₆	5 ¹¹ / ₃₂	5 ²¹ / ₃₂	390.0	
E986N	4	4	1 ²⁵ / ₃₂	17 ²³ / ₃₂	15 ⁷ / ₈	14 ¹⁷ / ₆₄	4 ⁷ / ₁₆	5 ¹¹ / ₃₂	5 ²¹ / ₃₂	390.0	

Diagram

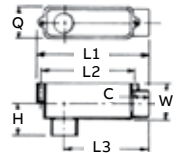

Type E

- Hubs are not threaded
- Textured lids
- Foam-in-place gasket

Cat. no.	Size (in.)	Std. ctn. qty.	C (in.)	L1 (in.)	L2 (in.)	Q (in.)	W (in.)	Vol. (cu. in.)
E988D	½	25	1 ¹ / ₁₆	4 ⁵ / ₁₆	3½	1 ¹¹ / ₃₂	1½	4.0
E988E	¾	15	2 ⁹ / ₃₂	6 ¹¹ / ₃₂	5 ⁹ / ₃₂	1¾	2 ¹ / ₃₂	12.0
E988F	1	10	2 ⁹ / ₃₂	6 ¹¹ / ₃₂	5 ⁹ / ₃₂	1¾	2 ¹ / ₃₂	12.0
E988G	1¼	10	1 ³ / ₃₂	8	6 ¹³ / ₃₂	2½	2¾	32.0
E988H	1½	10	1 ³ / ₃₂	8	6 ¹³ / ₃₂	2½	2¾	32.0
E988J	2	10	1 ⁵ / ₃₂	9 ¹⁵ / ₃₂	8 ¹³ / ₃₂	3 ⁵ / ₃₂	3 ¹⁵ / ₃₂	63.0

Diagram

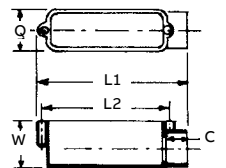

Conduit bodies



Type T

- Hubs are not threaded
- Textured lids
- Foam-in-place gasket

Cat. no.	Size (in.)	Std. ctn. qty.	Typical C (in.)	Max. L1 (in.)	Typical (in.)			Max. (in.)		Vol. (cu. in.)
					L2	L3	H	Q	W	
E983D-CAR	½	10	1 ¹ / ₁₆	4 ¹¹ / ₁₆	3 ⁷ / ₃₂	2 ¹¹ / ₃₂	1 ⁵ / ₁₆	1 ¹¹ / ₃₂	1½	4.0
E983E	¾	15	2 ⁹ / ₃₂	6 ⁷ / ₈	5 ⁹ / ₃₂	4 ⁷ / ₁₆	1 ²⁵ / ₃₂	1¾	2 ¹ / ₃₂	12.0
E983F	1	20	2 ⁹ / ₃₂	6 ⁷ / ₈	5 ⁹ / ₃₂	3 ⁷ / ₁₆	1 ²⁵ / ₃₂	1¾	2 ¹ / ₃₂	12.0
E983G	1¼	10	1 ³ / ₃₂	8 ²¹ / ₃₂	6 ¹³ / ₃₂	4 ²¹ / ₆₄	2 ⁵ / ₁₆	2½	2¾	32.0
E983H	1½	4	1 ³ / ₃₂	8 ²¹ / ₃₂	6 ¹³ / ₃₂	4 ²¹ / ₆₄	2 ⁵ / ₁₆	2½	2¾	32.0
E983J	2	10	1 ⁵ / ₃₂	10 ⁵ / ₁₆	8 ¹³ / ₃₂	5 ⁵ / ₃₂	2 ⁹ / ₁₆	3 ⁵ / ₃₂	3 ¹⁵ / ₁₆	63.0

Diagram

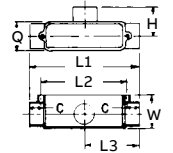

Type LR

- Hubs are not threaded
- Textured lids
- Foam-in-place gasket

Cat. no.	Size (in.)	Std. ctn. qty.	Typical C (in.)	Max. L1 (in.)	Typical (in.)			Max. (in.)		Vol. (cu. in.)
					L2	L3	H	Q	W	
E985D-CAR	½	10	1 ¹ / ₁₆	4 ⁵ / ₁₆	3 ⁷ / ₃₂	3 ¹ / ₁₆	1 ⁵ / ₁₆	1 ¹¹ / ₃₂	1½	4.0
E985E-CAR	¾	10	2 ⁹ / ₃₂	6 ⁹ / ₃₂	5 ⁹ / ₃₂	4 ²⁵ / ₃₂	1 ²⁵ / ₃₂	1¾	2 ¹ / ₃₂	12.0
E985F-CAR	1	10	2 ⁹ / ₃₂	6 ⁹ / ₃₂	5 ⁹ / ₃₂	4 ²⁵ / ₃₂	1 ²⁵ / ₃₂	1¾	2 ¹ / ₃₂	12.0
E985G-CAR	1¼	5	1 ³ / ₃₂	7 ³¹ / ₃₂	6 ¹³ / ₃₂	6	2 ⁵ / ₁₆	2½	2¾	32.0
E985H-CAR	1½	5	1 ³ / ₃₂	7 ³¹ / ₃₂	6 ¹³ / ₃₂	6	2 ⁵ / ₁₆	2½	2¾	32.0
E985J-CAR	2	3	1 ⁵ / ₃₂	9 ⁹ / ₃₂	8 ¹³ / ₃₂	7 ¹ / ₄	2 ⁹ / ₁₆	3 ⁵ / ₃₂	3 ¹⁵ / ₃₂	63.0

Diagram

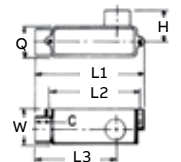

Conduit bodies



Type C

- Hubs are not threaded
- Textured lids
- Foam-in-place gasket

Cat. no.	Size (in.)	Std. ctn. qty.	Typical C (in.)	Max. L1 (in.)	Typical (in.)		Max. (in.)		Vol. (cu. in.)
					L2	Q	W		
E987D-CTN	1/2	8	1 1/16	4 1/16	3 1/2	1 1/32	1 1/2	4.0	
E987E-CAR	3/4	10	2 9/32	6 7/8	5 3/264	1 3/4	2 1/32	12.0	
E987F-CAR	1	10	2 9/32	6 7/8	5 9/32	1 3/4	2 1/32	12.0	
E987G-CAR	1 1/4	5	1 3/32	8 2 1/32	6 1 3/32	2 1/2	2 3/4	32.0	
E987H-CAR	1 1/2	4	1 3/32	8 2 1/32	6 1 3/32	2 1/2	2 3/4	32.0	
E987J	2	15	1 5/32	10 5/16	8 1 3/32	3 5/32	3 1 5/32	63.0	

Diagram

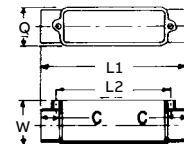

Type LL

- Hubs are not threaded
- Textured lids
- Foam-in-place gasket

Cat. no.	Size (in.)	Std. ctn. qty.	Typical C (in.)	Max. L1 (in.)	Typical (in.)			Max. (in.)		Vol. (cu. in.)
					L2	L3	H	Q	W	
E984D-CAR	1/2	10	1 1/16	4 5/16	3 7/32	3 1/16	1 1/16	1 1/32	1 1/2	4.0
E984E	3/4	20	2 9/32	6 9/32	5 9/32	4 2 5/32	1 2 5/32	1 3/4	2 1/32	12.0
E984F-CAR	1	10	2 9/32	6 9/32	5 9/32	4 2 5/32	1 2 5/32	1 3/4	2 1/32	12.0
E984G	1 1/4	10	1 3/32	7 3 1/32	6 1 3/32	6	2 5/16	2 1/2	2 3/4	32.0
E984H	1 1/2	10	1 3/32	7 3 1/32	6 1 3/32	6	2 5/16	2 1/2	2 3/4	32.0
E984J	2	10	1 5/32	9 9/32	8 1 3/32	7 1/4	2 9/16	3 5/32	3 1 5/32	63.0

Diagram

