

Copper H-tap connectors for copper conductors

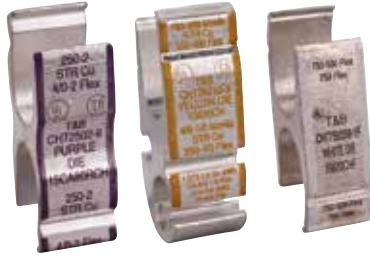

Material – High conductivity extruded copper

Finish – Electro tin plated



Copper H-taps – Certified to 600 V

Cat. no.	Fig. no.	Colour code	Wire size (AWG or kcmil)				Hydraulic head	Installing die	# of crimps	Colour code	Die code	Strip length (in.)	Insulating covers	Crimping information	
			Main	Branch 1	Branch 2	Branch 3									
CHT750350-1F	1	White	(750–500) (750) Flex only	(750–500) (350) Flex only	–	–	TBM15I	15620CHF	1	White	F	1½	HTC		
CHT750350-2	2	Yellow	750–500 (550–500)	750–500 (550–350)	–	–	TBM15I	15620CH	1	Yellow	Z	1¾	HTC500		
CHT75010-3	9	Yellow	750–500 (550–500)	4/0–1/0 (250–1/0)	1 Str. 2–6 AWG (1–8)	2–14 (2–14)	TBM15I	15620CH	1	Yellow	Z	1½	HTC500		
CHT50040-4	2	Brown	500–250 (350–4/0)	500–4/0 (350–4/0)	–	–	TBM15I	15612CH	2	Brown	N	1½	HTC500		
CHT50010-5	3	Brown	500–250 (350–4/0)	250–1/0 (4/0–1/0)	1 Str. 2–6 AWG (1–8)	8–14 (8–14)	TBM15I	15612CH	2	Brown	N	1½	HTC500		
CHT2502-6	2	Purple	250–2 (4/0–2)	250–2 (4/0–2)	–	–	•TBM15I TBM14M	15CA80RCH	1	Purple	80R	1⅜	HTC40		
CHT25014-7	4	Purple	250–2 (4/0–2)	2–6 Str./Sol. (2–8)	8–14 (8–14)	–	•TBM15I TBM14M	15CA80RCH	1	Purple	80R	1½	HTC40		
CHT250214-8	5	Purple	250–2 (4/0–2)	8–14 (8–14)	8–14 (8–14)	–	•TBM15I TBM14M	15CA80RCH	1	Purple	80R	1½	HTC40		
CHT214-9	6	Brown	2–6 Str./Sol. (2–8)	2–6 Str./Sol. (2–8)	8–14 (8–14)	8–14 (8–14)	•TBM15I TBM14M 13100A	15CA71RCH	3	Brown	71R	7/8	HTC40		
CHT814-10	7	Green	8–14 (8–14)	8–14 (8–14)	8–14 (8–14)	8–14 (8–14)	•TBM15I TBM14M 13100A	15CA37RCH	1	Green	37R	½	HTC25		
CHT75040-11	8	Yellow	750 Str. (750–500)	350–4/0 Str. Cu. & Flex	8–14 (8–14)	8–14 (8–14)	TBM15I	15620CH	1	Yellow	Z	1½	HTC500		

• Requires adaptor cat. no. 15500-TB when used with hydraulic head TBM15I.

Material: Copper per AS™ designation B-124-55 Alloy 12.

For tool and die selection charts, see the section E31-E48 of the Tools, Dies and Kits catalogue.

Copper H-tap connectors for copper conductors

Material – High conductivity extruded copper
Finish – Electro tin plated



Copper H-taps – Certified to 600 V (continued)

Cat. no.	Fig. no.	Dimensions in. (mm)									Strip length (in.)	Insulating covers
		H	W	L	A	D	D1	D2	D3			
CHT750350-1F	1	3.46 (87.9)	1.66 (42.1)	1.10 (27.9)	1.73 (43.9)	1.23 (31.2)	–	–	–	1 ¹ / ₈	HTC1000	
CHT750350-2	2	3.24 (82.3)	1.50 (38.1)	1.25 (31.8)	1.62 (41.1)	1.02 (30.5)	–	–	–	1 ³ / ₈	HTC500	
CHT75010-3	9	3.13 (79.5)	1.50 (38.1)	1.00 (25.4)	1.54 (39.1)	1.00 (25.4)	0.40 (10.2)	0.35 (8.9)	0.41 (10.4)	1 ¹ / ₈	HTC500	
CHT75040-11	8	3.19 (81.0)	(1) 1.65 (41.9) (2) 1.05 (26.7)	1.00 (25.4)	(1) 1.61 (40.9) (2) 1.29 (32.8)	(1) 1.24 (31.5) (2) 0.80 (20.3)	–	–	–	1 ¹ / ₈	HTC500	
CHT50040-4	2	2.64 (67.1)	1.18 (30.0)	1.00 (25.4)	1.32 (33.5)	0.80 (20.3)	–	–	–	1 ¹ / ₈	HTC500	
CHT50010-5	3	2.28 (57.9)	1.30 (33.0)	1.00 (25.4)	1.20 (30.5)	0.80 (20.3)	0.67 (17.0)	0.19 (4.8)	0.43 (10.9)	1 ¹ / ₈	HTC500	
CHT2502-6	2	1.99 (50.9)	0.90 (22.9)	0.66 (16.8)	1.00 (25.4)	0.62 (15.7)	–	–	–	1 ³ / ₁₆	HTC40	
CHT25014-7	4	1.63 (41.4)	0.90 (22.9)	0.90 (22.9)	0.96 (24.4)	0.52 (13.2)	0.35 (8.9)	0.19 (4.8)	–	1 ¹ / ₈	HTC40	
CHT250214-8	5	1.63 (41.4)	0.90 (22.9)	0.90 (22.9)	0.96 (24.4)	0.62 (15.7)	0.19 (4.8)	0.19 (4.8)	–	1 ¹ / ₈	HTC40	
CHT214-9	6	1.35 (34.3)	0.60 (15.2)	0.75 (19.1)	0.50 (12.7)	0.33 (8.4)	0.19 (4.8)	0.19 (4.8)	–	7/8	HTC40	
CHT814-10	7	0.62 (15.7)	0.60 (15.2)	0.37 (9.4)	0.25 (6.4)	0.16 (4.1)	–	–	–	1/2	HTC2S	

Diagrams

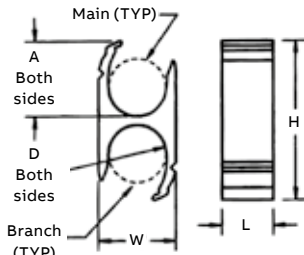

Figure 1

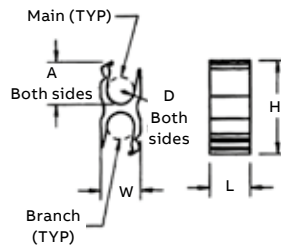

Figure 2

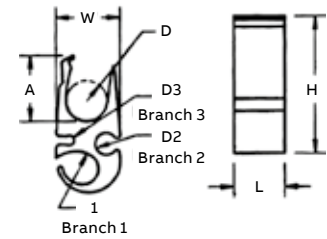

Figure 3

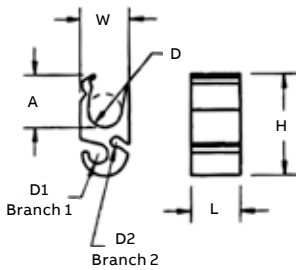

Figure 4

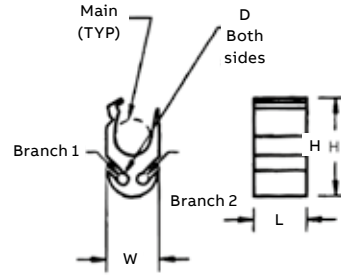

Figure 5

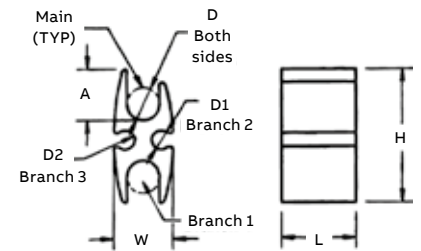

Figure 6

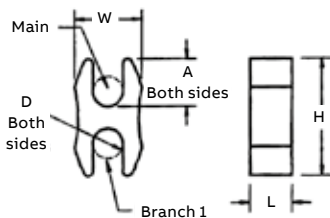

Figure 7

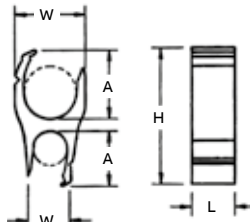

Figure 8

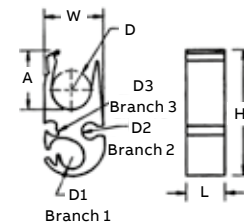

Figure 9

Aluminum H-tap connectors

Exclusive FILLERLOK tab design



Material – High-conductivity wrought aluminum

- H-type compression taps
- For aluminum-to-aluminum, aluminum-to-copper and copper-to-copper stranded-conductor applications
- Concentric and compact code strandings



Copper H-taps – Certified to 600 V 90°C applications

Cat. no.	Wire combinations (AWG or kcmil)			Length (in.)	Die code cat. no.				Colour code
	Main	Branch	Side tap		TBM6-TBM6S TBM6ORS	Hydraulic TBM14M 13100A	TBM12 12-ton head	TBM151 15-ton head	
63105†	2-6	8-14	-	¾	13474 - upper 13477 - lower	15530	TBM12D-4	15530*	Orange
63110	4-6	4-6	-	1½	13470	15501A	TBM12D-H	15001A*	Green
63118	2/0-2	8-14	-	¾	13470	15501A	TBM12D-H	15001A*	Green
63125	2/0-2	1/0-6	-	1½	13470	15501A	TBM12D-H	15001A*	Green
63140	4/0-2/0	2-10	-	1½	13471	15502	TBM12D-H	15502*	Blue
63148•	4/0-2/0	3/0-1	8-14	3	-	-	TBM12D-H	15502	Blue
63160	500-4/0	4/0-2	2-6	2¾	-	-	-	15612	Red
63169	750-4/0	750-4/0	-	3	-	-	-	15620	Black
63170	1,000-500	1,000-1/0	-	6	-	-	-	15620	Black
63180	750-350	350-1/0	1-6	3	-	-	-	15620	Black

* Use with adaptor cat.no.15500-TB.

† 63105 also installed by TBM5/TBM5S with 13455 die or TBM8/TBM8S with 13462 die.

• 63148 - #1 CU or AL - wire bent double (hairpin).

For Smart™ tools installation

63110,63118,63125: Use TBM8-750HG

63140,63148:Use TBM8-750BH

For tool and die selection charts, see the section E31-E48 of the Tools, Dies and Kits catalogue.

Interlocking insulating covers for compression taps

Better covers for taps

- 01 Smaller size requires less space in enclosure. High-impact polypropylene for rugged, dependable use.
- 02 Clear, polycarbonate (UL94V-0) version available.
- 03 Easy latch mechanism.

Soft shell H-tap/C-tap covers

ABB offers an improved design for one-piece covers for H-tap and C-tap connectors. The design is more size-efficient and includes an easy latch mechanism. The new covers also contain flash barriers to help protect against electrical flash overs. The covers are molded from high-impact polypropylene (UL94V-1) and are UL® listed, CSA certified to 600 V applications at 105 °C.

The soft shell covers include these features:

- **Size-efficient design**
Won't take up as much room in the enclosure or vault, easier to store and carry to the job site
- **Easy latch mechanism**
Quick but sturdy cover latch for optimum insulation
- **Flash barriers**
Provides protection from electrical flashovers
- **105 °C rating**
Offers maximum performance and higher than many competitors' temperature ratings
- **High-impact polypropylene**
Constructed from rugged materials for long-lasting protection

Also available in clear, impact-resistant and flame-retardant polycarbonate (UL94V-0). The clear version includes an internal pocket for a visible identification label without opening the cover. Contact Customer Service for shipping and availability.



01



02



03

Soft shell H-tap/C-tap covers



Cat. no.	For H-taps	For C-taps	Dimensions (in.)			Std. qty.
			A	B	C	
HTCV1	CHT814-10	54705, 54710, 54715	1 3/4	7/8	9/16	5
HTCV2	CHT214-9, CHT250214-8, CHT25014-7, CHT2502-6	54770, 54775, 54780	3 3/8	1 1/8	1	5
HTCV3	CHT50010-5, CHT50040-4	54740, 54745, 54750, 54755, 54760, 54765	3 27/32	1 5/8	1 5/16	5
HTCV4	CHT75010-3, CHT750350-2, CHT750350-1F, CHT75040-11	—	5 5/8	2	1 11/16	5
HTCV2CLRFR	CHT214-9, CHT250214-8, CHT25014-7, CHT2502-6	—	3 3/8	1 3/8	1	5

Diagrams

