

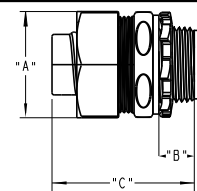

Liquidtight conduit fittings

Malleable iron fittings

- Heavy-duty malleable iron
- Zinc electroplated for corrosion resistance
- Tapered threaded hub complete with flange gasket and steel locknut
- Temperature range: -25 °C to 90 °C

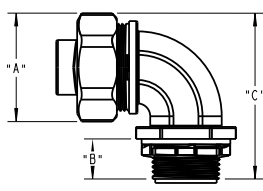

| Cat. no. | Trade size (in.) | KO size (in.) | Dimensions (in.) | | | | |
|---|---|---------------|------------------|--------|---------|--------|---------|
| | | | A | B | C | | |
| Straight liquidtight fittings (steel) | | | | | | | |
|  |  | CI6103 | 3/8 | 1/2 | 1 1/16 | 9/16 | 1 3/8 |
| | | CI6104 | 1/2 | 1/2 | 1 3/16 | 9/16 | 1 3/4 |
| | | CI6106 | 3/4 | 3/4 | 1 7/16 | 9/16 | 1 5/8 |
| | | CI6108 | 1 | 1 | 1 11/16 | 1 1/16 | 2 3/16 |
| | | CI6110 | 1 1/4 | 1 1/4 | 2 1/8 | 1 1/16 | 2 3/8 |
| | | CI6112 | 1 1/2 | 1 1/2 | 2 3/8 | 1 1/16 | 2 9/16 |
| CI6116 | 2 | 2 | 2 15/16 | 1 3/16 | 2 3/4 | | |
| Straight liquidtight fittings – insulated throat (malleable iron) | | | | | | | |
| CI6103-IT | 3/8 | 1/2 | 1 1/16 | 9/16 | 1 3/8 | | |
| CI6104-IT | 1/2 | 1/2 | 1 3/16 | 9/16 | 1 3/4 | | |
| CI6106-IT | 3/4 | 3/4 | 1 7/16 | 9/16 | 1 5/8 | | |
| CI6108-IT | 1 | 1 | 1 11/16 | 1 1/16 | 2 3/16 | | |
| CI6110-IT | 1 1/4 | 1 1/4 | 2 1/8 | 1 1/16 | 2 3/8 | | |
| CI6112-IT | 1 1/2 | 1 1/2 | 2 3/8 | 1 1/16 | 2 9/16 | | |
| CI6116-IT | 2 | 2 | 2 15/16 | 1 3/16 | 2 3/4 | | |
| 90° liquidtight fittings (malleable iron) | | | | | | | |
|  |  | CI6303 | 3/8 | 1/2 | 1 1/16 | 9/16 | 2 |
| | | CI6304 | 1/2 | 1/2 | 1 3/16 | 9/16 | 2 1/16 |
| | | CI6306 | 3/4 | 3/4 | 1 7/16 | 9/16 | 2 1/2 |
| | | CI6308 | 1 | 1 | 1 11/16 | 1 1/16 | 2 15/16 |
| | | CI6310 | 1 1/4 | 1 1/4 | 2 1/8 | 1 1/16 | 3 3/16 |
| | | CI6312 | 1 1/2 | 1 1/2 | 2 3/8 | 1 1/16 | 3 1/2 |
| CI6316 | 2 | 2 | 2 15/16 | 1 3/16 | 4 5/16 | | |
| 90° liquidtight fittings – insulated throat (malleable iron) | | | | | | | |
| CI6303-IT | 3/8 | 1/2 | 1 1/16 | 9/16 | 2 | | |
| CI6304-IT | 1/2 | 1/2 | 1 3/16 | 9/16 | 2 1/16 | | |
| CI6306-IT | 3/4 | 3/4 | 1 7/16 | 9/16 | 2 1/2 | | |
| CI6308-IT | 1 | 1 | 1 11/16 | 1 1/16 | 2 15/16 | | |
| CI6310-IT | 1 1/4 | 1 1/4 | 2 1/8 | 1 1/16 | 3 3/16 | | |
| CI6312-IT | 1 1/2 | 1 1/2 | 2 3/8 | 1 1/16 | 3 1/2 | | |
| CI6316-IT | 2 | 2 | 2 15/16 | 1 3/16 | 4 5/16 | | |

Liquidtight conduit fittings

Zinc alloy fittings



CI6603 (-IT) / CI6632 (-IT)

IT: with insulated throat

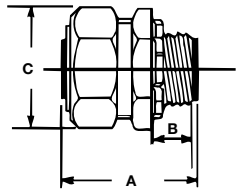

| Cat. no. | Trade size (in.) | KO size (in.) | Dimensions (in.) | | |
|---|------------------|---------------|------------------|------|------|
| | | | A | B | C |
| Straight liquidtight fittings (zinc alloy) | | | | | |
| CI6603 | 3/8 | 1/2 | 1.58 | 0.53 | 1.18 |
| CI6604 | 1/2 | 1/2 | 1.52 | 0.53 | 1.29 |
| CI6606 | 3/4 | 3/4 | 1.69 | 0.53 | 1.57 |
| CI6608 | 1 | 1 | 2.06 | 0.58 | 1.81 |
| CI6610 | 1 1/4 | 1 1/4 | 2.06 | 0.61 | 2.18 |
| CI6612 | 1 1/2 | 1 1/2 | 2.09 | 0.63 | 2.51 |
| CI6616 | 2 | 2 | 2.15 | 0.63 | 3.03 |
| CI6620 | 2 1/2 | 2 1/2 | 3.54 | 1.02 | 3.68 |
| CI6624 | 3 | 3 | 4.05 | 1.07 | 4.38 |
| CI6632 | 4 | 4 | 4.99 | 1.15 | 5.54 |

Straight liquidtight fittings – insulated throat (zinc alloy)

| | | | | | |
|-----------|-------|-------|------|------|------|
| CI6603-IT | 3/8 | 1/2 | 1.66 | 0.63 | 1.18 |
| CI6604-IT | 1/2 | 1/2 | 1.62 | 0.63 | 1.29 |
| CI6606-IT | 3/4 | 3/4 | 1.79 | 0.63 | 1.57 |
| CI6608-IT | 1 | 1 | 2.16 | 0.68 | 1.81 |
| CI6610-IT | 1 1/4 | 1 1/4 | 2.16 | 0.71 | 2.18 |
| CI6612-IT | 1 1/2 | 1 1/2 | 2.19 | 0.73 | 2.51 |
| CI6616-IT | 2 | 2 | 2.25 | 0.73 | 3.03 |
| CI6620-IT | 2 1/2 | 2 1/2 | 3.64 | 1.12 | 3.68 |
| CI6624-IT | 3 | 3 | 4.15 | 1.17 | 4.38 |
| CI6632-IT | 4 | 4 | 5.09 | 1.25 | 5.54 |



CI6703 (-IT) / CI6716 (-IT)

IT: with insulated throat

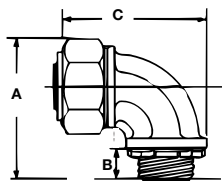

90° liquidtight fittings (zinc alloy)

| | | | | | |
|---------|-------|-------|------|------|------|
| CI6703 | 3/8 | 1/2 | 2.11 | 0.53 | 2.53 |
| CI6704 | 1/2 | 1/2 | 2.24 | 0.53 | 2.46 |
| CI6706 | 3/4 | 3/4 | 2.47 | 0.55 | 2.79 |
| CI6708 | 1 | 1 | 3.46 | 0.58 | 3.86 |
| CI6710 | 1 1/4 | 1 1/4 | 3.37 | 0.67 | 3.99 |
| CI6712 | 1 1/2 | 1 1/2 | 4.28 | 0.61 | 5.04 |
| CI6716 | 2 | 2 | 4.21 | 0.71 | 5.06 |
| LT-297 | 2 1/2 | 2 1/2 | 4.32 | 0.88 | 3.65 |
| LT-298 | 3 | 3 | 4.81 | 0.88 | 4.32 |
| LT-2910 | 4 | 4 | 5.32 | 0.88 | 5.32 |

90° liquidtight fittings – insulated throat (zinc alloy)

| | | | | | |
|-----------|-------|-------|------|------|------|
| CI6703-IT | 3/8 | 1/2 | 2.27 | 0.63 | 2.53 |
| CI6704-IT | 1/2 | 1/2 | 2.24 | 0.63 | 2.46 |
| CI6706-IT | 3/4 | 3/4 | 2.54 | 0.65 | 2.79 |
| CI6708-IT | 1 | 1 | 3.25 | 0.68 | 3.86 |
| CI6710-IT | 1 1/4 | 1 1/4 | 3.50 | 0.77 | 3.99 |
| CI6712-IT | 1 1/2 | 1 1/2 | 4.30 | 0.71 | 5.04 |
| CI6716-IT | 2 | 2 | 5.16 | 0.81 | 5.06 |

Tapered threaded hub complete with zinc die cast locknut