

Insulation piercing connectors

Type IPC – Talon™



- Perform as a splice or tap for non-tension applications up to 600 volts depending on the size of the connector
- Eliminate need for conductor insulation stripping
- Self-insulated for hot line applications
- No taping required after installation
- For copper-to-copper, copper-to-aluminum and aluminum-to-aluminum applications
- For use on insulated conductors only
- Six-connector line covers the range from #10 AWG–500 kcmil



Cat. no.	Al or Cu conductor range (AWG/kcmil)		No. of bolts	Fig.	Dimensions (in.)		
	Main	Tap			W	H	L
IPC1102*	1/0–8 50–6	2–8 35–6	1	1	2 ⁹ / ₁₆	2	1 ¹⁷ / ₃₂
IPC4111	4/0–1/0 95–50	1/0–6 50–16	2	2	2 ¹ / ₂	2	1 ¹⁹ / ₃₂
IPC4141	4/0–1/0 95–50	4/0–1/0 95–50	2	2	2 ⁵ / ₈	3 ¹ / ₄	1 ²⁹ / ₃₂
IPC5041*	500–350 240–185	4/0–4 90–25	1	1	2	2 ¹ / ₂	2 ¹ / ₈
IPC3535	350–4/0 185–95	350–4/0 185–95	2	2	2 ¹ / ₁₆	2 ¹ / ₂	2 ¹ / ₈
IPC3541V	350–4/0 185–95	4/0–10 95–6	1	1	2 ³ / ₄	3	2 ¹ / ₈

Diagrams

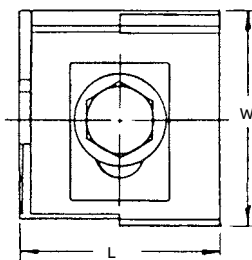

Fig. 1

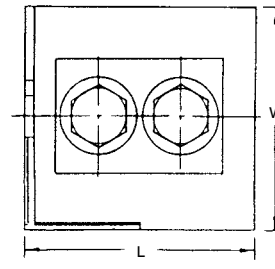
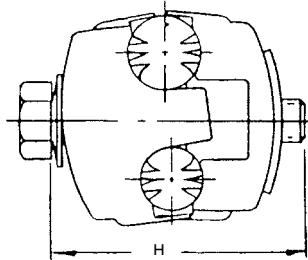
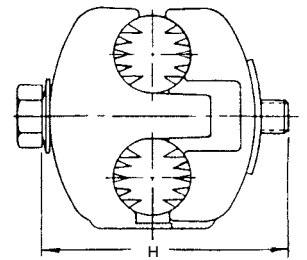

Fig. 2



* 600 volt rating (All others 300 volts).